

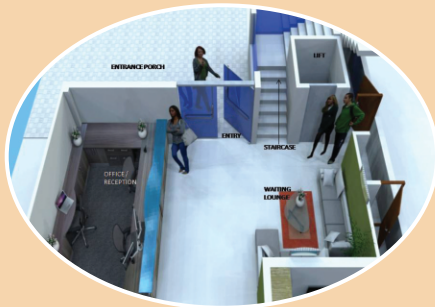

VASAVI BHAVAN OF SRI SHIRDI SAI VASAVI CHARITABLE TRUST (R) VASAVI ANNA SANTARPANA BHAVAN



Reg Office : # 85, 1st Floor, G.R.Complex, 1st Cross, 3rd Main, N.T.Pet, Bangalore - 560 002.



HERITAGE DONOR (ROOM)	5,04,000.00	30 Days in a year (25 Years)	
PLATINUM DONOR	3,24,000.00	20 Days in a year (22 Years)	
GOLD DONOR	2,16,000.00	12 Days in a year (20 Years)	
SILVER DONOR	1,08,000.00	8 Days in a year (15 Years)	
BRONZE DONOR	54,000.00	5 Days in a year (12 Years)	

CHEQUES / DD HAS BEEN DRAWN INFAVOUR OF SRI SHIRDI SAI VASAVI CHARITABLE TRUST (R)

PLEASE FILL THE APPLICATION IN CAPITAL LETTERS

1. NAME :

2. FATHER'S NAME :

3. AGE :

4. DATE OF BIRTH :

5. DATE OF MARRIAGE :

6. SPOUSE NAME :

7. DATE OF BIRTH :

8. FIRM NAME :

9. POSTAL ADDRESS :

10. TELEPHONE NO :

11. MOBILE NO :

12. EMAIL :

PASSPORT SIZE
PHOTOS - 3

FOR OFFICE USE :

REFERED BY :

SIGNATURE OF APPLICANT